

Product PASSIVE PFC	Size EI38-13.6	Type POTTED
-------------------------------	--------------------------	-----------------------

Product designation

PASSIVE PFC CHOKES - EI38x13.6 - POTTED

I MECHANICAL CHARACTERISTICS - PINOUT

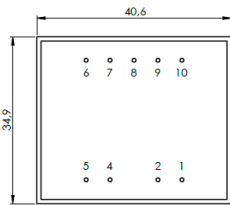
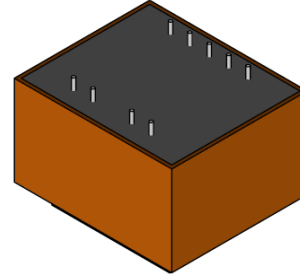
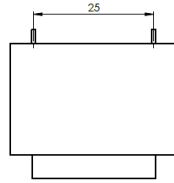
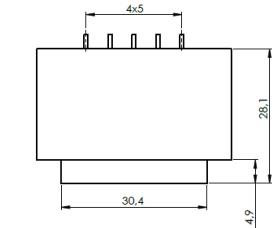

Terminals	
Pins	Ø 0.80 +/- 0.10 mm
PCB recommended drilling diameter	1.3 mm
Pins length	4.0 +/- 0.5 mm
Missing pin	position 3
Tolerances	
General tolerance	+/- 0.5 mm
Pins pitch tolerance	+/- 0.5 mm
Pins row tolerance	+/- 0.5 mm

II ELECTRICAL CHARACTERISTICS - ENVIRONMENTAL

Typical use at ambient 70 °C

Reference	Inductance (mH)	Rated current (A _{RMS})	Sat. current (A _{pk})	Temperature class	Type
43210	1.0	4.7	10.5	T70 / B	2
43211	1.5	4.6	7.7	T70 / B	1
43212	2.0	4.2	6.4	T70 / B	1
43213	2.5	3.8	6.2	T70 / B	2
43214	3.0	3.4	5.2	T70 / B	2
43215	3.5	3.3	5.1	T70 / B	1
43216	4.0	3.2	5.0	T70 / B	2
43217	4.5	2.9	4.6	T70 / B	2
43218	5.0	2.7	4.0	T70 / B	2
43219	10.0	1.9	2.8	T70 / B	1
43220	15.0	1.5	2.5	T70 / B	2

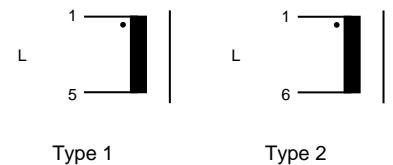

Operating temperature - 40 / + 120 °C

Storage temperature - 40 / + 85 °C

Rated currents (A_{RMS}) will give temperature rising of 40 K.

Saturation currents (A_{pk}) are stated for a maximum inductance drop of 20%

III SAFETY - APPROVAL

RoHS and REACH compliant

UL94 V-0 materials

Construction conforms to the certified MYRRA Class B UL Electrical Insulation System E113497-B.